

|                            | SL SHERMAN 1                          | SL SHERMAN 2                                 |
|----------------------------|---------------------------------------|--|
| TOTAL STC DC SYSTEM SIZE   | 6463.2 kW                             | 6520.8 kW                                    |
| SOLAR MODULE MODEL         | CANADIAN SOLAR KUMAX 365P             | JINKO CHEETA PLUS HC 440                     |
| SOLAR MODULE STC DC RATING | 365 W                                 | 440 W  |
| SOLAR MODULE INFO          | 78.7" x 39.1" x 1.38", 49.6 lbs       | 85.3" x 39.3" x 1.57", 54.0 lbs              |
| SOLAR MODULE COUNT         | 17,680                                | 14,820                                       |
| STRING SIZE                | 29 x [26M x 22S], 2 x [26M x 21S]     | 30 x [26M x 14S], 10 x [26M x 15S]           |
| RACKING SYSTEM             | RBI SOLAR GM2 RACKING                 | RBI SOLAR GM2 RACKING                        |
| PITCH OF ARRAY             | 20°                                   | 20°  |
| INVERTER MODEL             | 31 x SMA SUNNY HIGHPOWER PEAK3 150-US | 40 x CHINT POWER SYSTEMS SCH125KTL-DO/US-600 |
| ARRAY AZIMUTH              | 180°                                  | 180°   |
| MIN. CLEARANCE TO GROUND   | 3'-0"                                 | 3'-0"  |
| INTERCONNECTION VOLTAGE    | 34.5kV, 3-PH, 3-WIRE (N. GRID)        | 34.5kV, 3-PH, 3-WIRE (N. GRID)               |

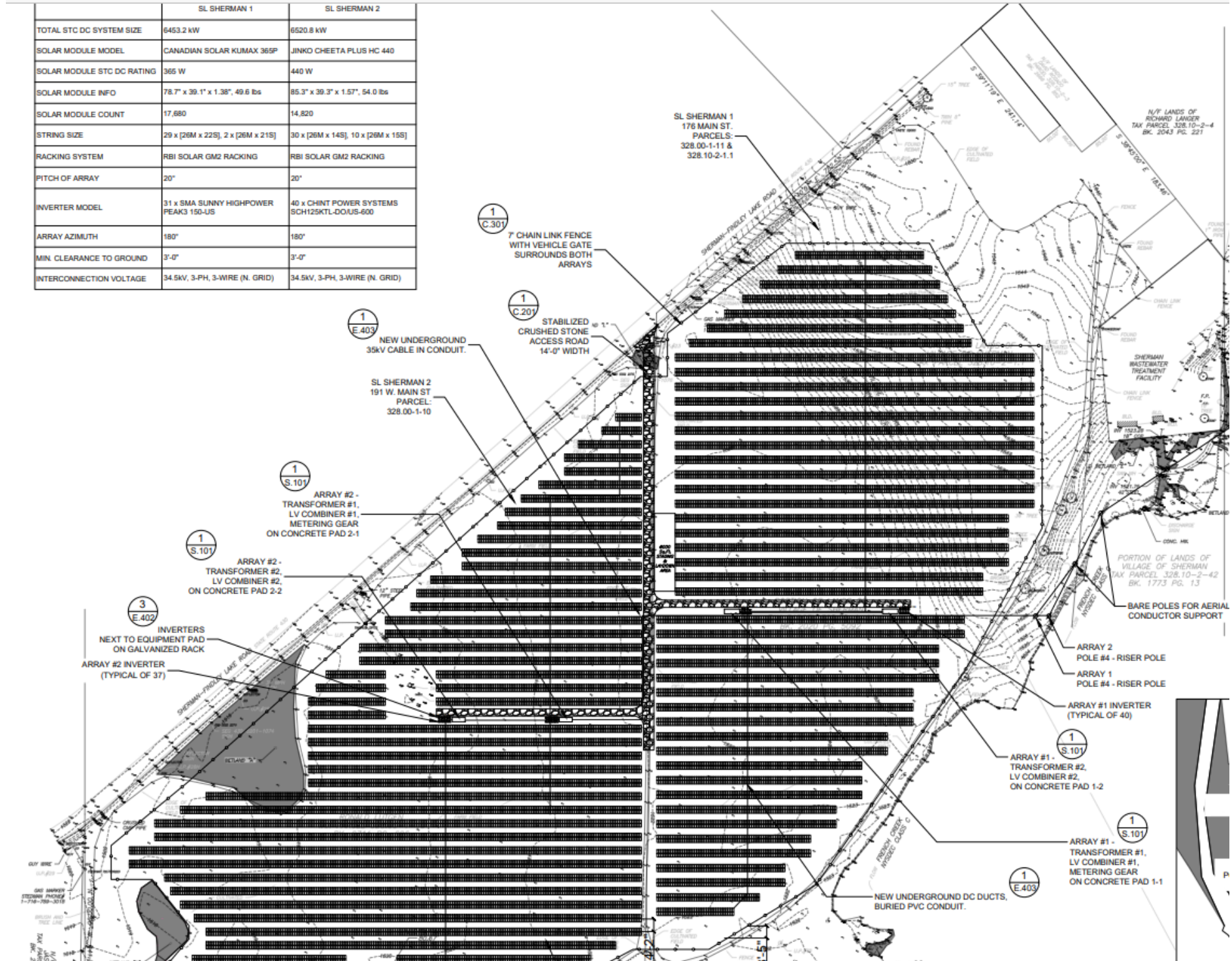

N/W LANDS OF RICHARD LANGER TAX PARCEL 328.10-2-4 BK. 2043 PG. 221

PORTION OF LANDS OF VILLAGE OF SHERMAN TAX PARCEL 328.10-2-42 BK. 1773 PG. 13

